



**Violetta Tudorache**

+40 729 005 624

contact@blissimobiliare.ro  
(mailto:contact@blissimobiliare.ro)

Updated on 4 May 2026

## Bright 1-Bedroom Apartment with Balcony

Cloud9 Residence, Aviatiei Manastirea  
Cristiana, Bucharest

**175,000 EUR** +VAT

Web Reference  
**#145502**

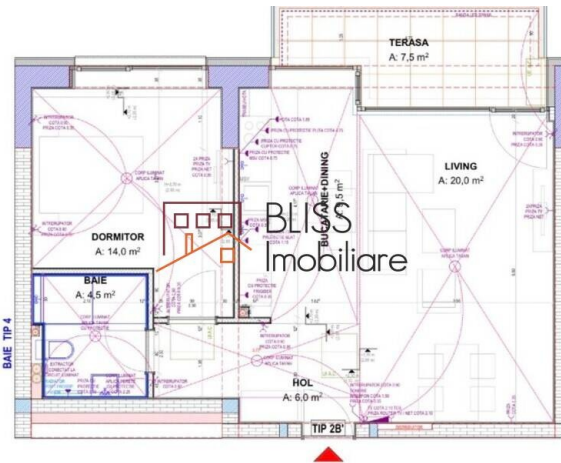

<https://blissimobiliare.ro/index.php/en/apartment-1-bedroom-for-sale-aviatiei-promenada-mall-metro-pipera-bucharest-145502> (<https://blissimobiliare.ro/index.php/en/apartment-1-bedroom-for-sale-aviatiei-promenada-mall-metro-pipera-bucharest-145502>)

### Description

This bright 1-bedroom apartment offers a well-balanced living space, designed for a modern and comfortable urban lifestyle. With 54 sqm of usable area and 61 sqm of built area, the property stands out through its detached layout, southern orientation and generous natural light.

### Modern urban comfort in a premium residential complex

Located on the 7th floor of a building with elevator, the apartment includes 1 bedroom, 1 kitchen, 1 bathroom and 1 balcony, creating a practical and efficient residential setup. The property is unfurnished, allowing the future owner to personalize the interior according to their own lifestyle and preferences.

Heating is provided by the building, while Cloud9 Evolution adds significant value through its modern residential facilities: green areas, walking alleys, parking spaces, including for electric cars and motorcycles, children's playground, sports court, fitness room, school, kindergarten, café, supermarket, body aesthetics center and easy access to commercial facilities.

The location in Aviației provides quick access to the business district, metro station, Promenada Mall, Herăstrău Park and key points of interest in northern Bucharest. It is a suitable choice for those looking for comfort, urban mobility and a cosmopolitan lifestyle.

For more details about this property, BLISS Immobiliare is ready to provide complete information and dedicated real estate guidance.



## Property details

<b>Rooms no.</b>	2
<b>Useable surface</b>	54m <sup>2</sup>
<b>Constructed surface</b>	61m <sup>2</sup>
<b>Apartment type</b>	Apartment
<b>Type of rooms</b>	Independent
<b>Type of comfort</b>	Comfort 1
<b>Bedrooms no.</b>	1
<b>Kitchens no.</b>	1
<b>Bathrooms no.</b>	1
<b>Building type</b>	Block
<b>Year built</b>	2020
<b>Config</b>	2S+P+11
<b>Floor</b>	7
<b>Balconies no.</b>	1
<b>State</b>	Finished
<b>Elevator</b>	Yes

## Amenities

 Not furnished

 Building heating



## Location

